

460T Expandable PVC Coupling • Spec Sheet

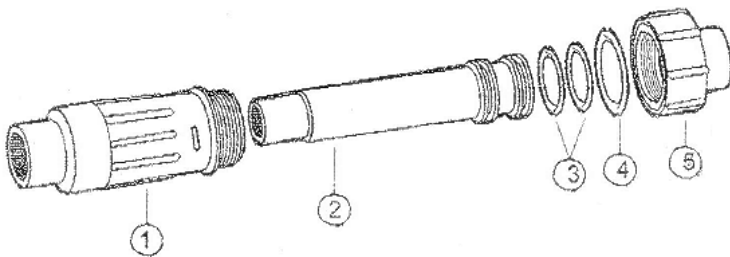

FEATURES & BENEFITS

- Expandable Coupling
- Heavy PVC Construction
- Union Style & Double O- Ring Slider
- NSF Approved
- Complies with ASTM D1784 & D2466
- Rated at 160 PSI at 73° F
- For Cold Water Only



MATERIAL SPECIFICATIONS

No.	Part	Material
1	Body	PVC
2	Slip Tube	PVC
3	O-Rings	Rubber
4	O-Rings	Rubber
5	Compression Nut	PVC

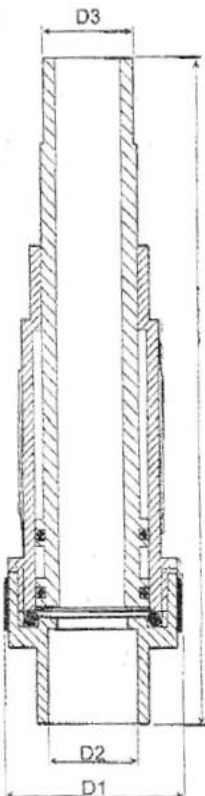

DIMENSIONS

Size	Part #	D1	D2	D3	L	Expands	
						From	To
1/2"	460T03	1.90	0.848	0.84	6.67	5-3/4	8-1/2
3/4"	460T04	2.12	1.058	1.05	7.54	7-1/2	9-3/4
1"	460T05	2.59	1.325	1.32	8.74	8-3/4	11-1/4
1-1/4"	460T06	2.99	1.670	1.66	9.79	9	11-3/4
1-1/2"	460T07	3.26	1.912	1.89	9.94	10	13
2"	460T08	3.72	2.387	2.37	11.33	11-1/4	14-1/4
2-1/2"	460T09	4.22	2.889	2.87	12.60	12-1/2	17
3"	460T10	4.94	3.516	3.49	13.45	13-1/4	17-3/4
4"	460T11	6.18	4.518	4.49	14.83	14-3/4	19-1/2

 **MATCO-NORCA**
Global sourcing. National compliance. Local service.

CALIFORNIA 5593 Fresca Dr., La Palma CA 90623 • Toll Free: 866-532-8306 • Fax: 866-532-8307
TEXAS 1150 Silber Rd., Houston TX 77055 • Toll Free: 800-935-5456 • Fax: 713-680-2999
NEW YORK PO Box 27, Rt. 22, Brewster NY 10509 • Toll Free: 800-431-2082 • Fax: 845-278-9056
 WEB: www.matco-norca.com EMAIL: mail@matco-norca.com